

Timber Roller Shutter

Timber Roller Shutters



The natural beauty and warmth of timber makes the Timber Roller Shutter a perfect solution for internal applications such as counters, bars, clubrooms, churches and showrooms. Its elegant curtain design enables quiet operation and can be polished or stained to complement the surrounding décor.

FEATURES

- Appealing timber design
- Quiet operation
- Natural finish

DOOR DIMENSIONS

- Maximum Height: 2300mm*
- Maximum Width: 3000mm*

*Total size must not exceed 5.2m².

RECOMMENDED SPECIFICATIONS

Timber Roller Shutter with 45mm high slats in 17mm thick material as manufactured by Airport Doors. The Roller Shutter operates by means of a flexible timber slatted curtain winding onto an overhead drum and guided in timber or aluminium door guides.

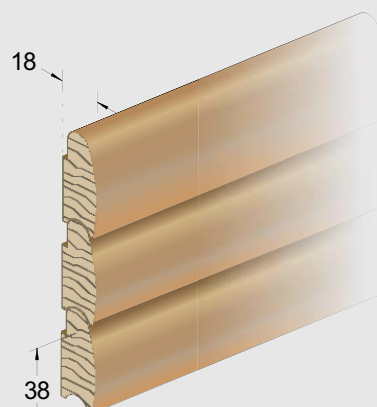

© Copyright 2015 Czapp Pty Ltd trading as Airport Doors.
In line with Airport Doors' research and development program, Airport Doors reserves the right to change specifications at any time without notice.

Timber Roller Shutter

Timber Roller Shutters

CURTAIN

The Timber Roller Shutter curtain is manufactured from specially moulded 45 mm high by 17mm thick Mountain Ash timber slats. The slats are morticed internally and lined with spring steel straps and copper straps cushioned by cotton webbing. The copper straps and cotton webbing are countersunk screwed from the back to link the slats together.

FINISH

Mountain Ash timber slats are sanded smooth and supplied untreated. Polish or stain can be applied to the slats at a later date by client.

NOTE: Polyurethane or other lacquer finishes are not suitable for timber shutters.

BOTTOM RAIL

The bottom rail is manufactured from 90mm high by 17mm wide timber moulding.

DOOR GUIDES

Timber Roller Shutter standard door guides are manufactured from 2mm thick, 50mm x 30mm extruded aluminium. Where the opening is uneven or not plumb, door guides are used in conjunction with 'take-up' channels (limitations may apply).

In some cases door guides can be manufactured from specially moulded timber of 65mm by 55mm.

NOTE: Where aluminium mullions are required, door guides will be aluminium.

DRUM & SPRING ASSEMBLY

The drum is manufactured from galvanised spiral duct tube revolving around a central steel axle and encasing helical torsion springs matched to suit door size and weight. The drum is attached to nylon drum wheels, which provide bearing support to the shaft, and completely conceal the springs. The drum is designed to provide minimal deflection over the door width.

DRUM SUPPORT BRACKETS

Timber Roller Shutter drum support brackets are manufactured from either mild steel plate with a thickness of 3mm, or mild steel angle brackets both matched to suit door size and weight. The drum support brackets are prime-coated and are fixed to the wall using masonry anchors or hex head screws, or as specified for steel work.

FIXING REQUIREMENTS

The building construction (typically timber, steel or core-filled brick) must be structurally sound and have adequate strength to support the Roller Shutter and its fixing requirements. Consult manufacturer for further details.

LOCKING

Standard locking is by means of two 100mm long chrome or brass plated barrel bolts fitted externally to each side of the bottom rail.

MULLIONS (OPTIONAL)

Centre door mullions can be used for wide openings to create multiple door installations. Timber Roller Shutter centre door mullions, of either removable or fixed type, are manufactured from aluminium extrusion with a standard width of 125mm. Where aluminium mullions are required, aluminium door guides will be used instead of the standard timber door guides. Fixed centre door mullions can alternatively be fabricated from timber when specified, however restrictions may apply. Consult the manufacturer for further information.

Fixed and removable corner mullions are manufactured in aluminium. Specifications may differ from application to application.

OPERATION

The Timber Roller Shutter operates by means of a flexible interlocking timber curtain, winding onto an overhead drum and guided in timber door guides. Timber Roller Shutters can be installed 'behind-fix' or 'between-fix' and are available as hand operated or motorised.

HAND OPERATION

Timber Roller Shutters are designed for hand-operation up to 2000 high by 2000 wide.

MOTORISATION

Standard motorisation is via a 24v DC motor with a wall push-button that opens and closes the door. The operator plugs into a standard GPO and consists of an emergency manual release mechanism in case of power outage.

Alternatively Timber Roller Shutters can be motorised using a tubular motor fitted inside the drum. Tubular motors are available in single-phase 240v or 24DC/240v. A manual override mechanism is available to enable manual operation in case of power outage.

Operator selection is dependent on the door size, door weight and the door's application.

The provision of adequate mains power supply and GPO or isolator (as required) to motor location is the responsibility of the client. Wiring from the isolator and commissioning of the door, motor controllers and any ancillary hardware is by client, unless otherwise stated in writing.

Optional extras, such as access control accessories (e.g. remote control, key switches etc.) and photo electric beams for added safety, are available upon specification. For further information see Door Operators & Accessories.

NOTE: Where between-fix is required, tubular motor is used as standard.

OPTIONS

- Mullions: removable or fixed
- Between-fix installation

Timber Roller Shutter

Technical Specs: Timber Roller Shutters

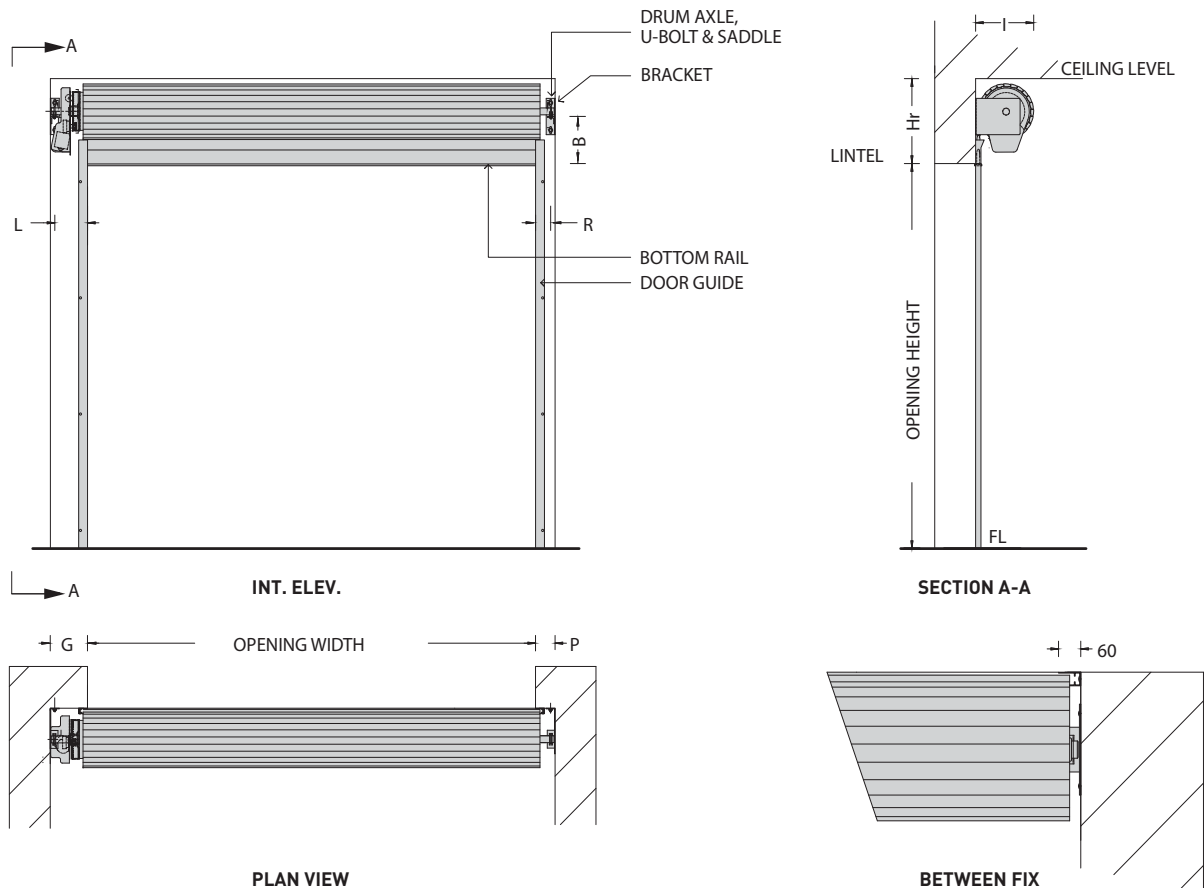

CLEARANCE DETAILS

HEIGHT UP TO	WIDTH UP TO 3m			OPERATION	DRIVEN END		PLAIN END	
	Hr	B	I		G	L	P	R
1100	510	340	270	HAND OPERATION	P	R	100	70
1700	530	355	310	MOTORISATION (STD)	250	190	100	70
2300	560	370	360	MOTORISATION (TUBULAR)	100	80	100	70

Notes:

- *For 'between-fix' installation, G & P = 0.
- Total door size must not exceed 5.2m².

Door Guides

Technical Specs: Timber Roller Shutter

TIMBER ROLLER SHUTTER STANDARD DOOR GUIDES

BEHIND WALL FIXING

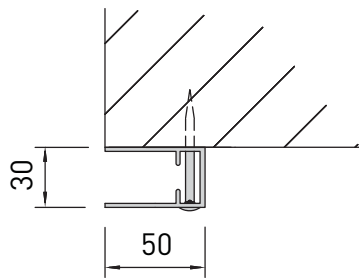

Aluminium Guide

BETWEEN WALL FIXING

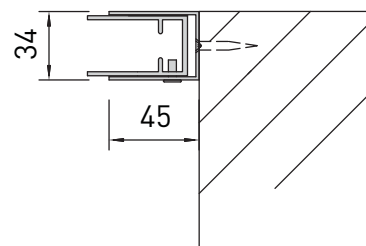

Aluminium Guide With Take Up Channel

NOTE: Where aluminium mullions are required for Timber Roller Shutters, door guides will be aluminium, as per above.

NON STANDARD DOOR GUIDES

BEHIND WALL FIXING

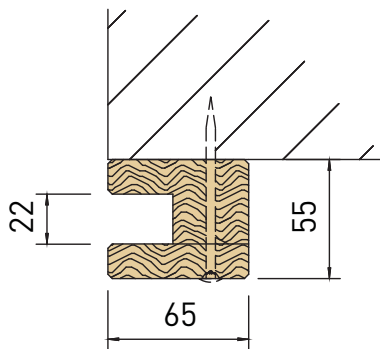

Timber Guide

BETWEEN WALL FIXING

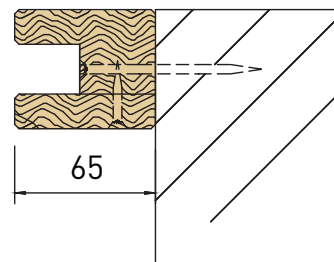

Timber Guide With Take Up Channel

NOTE: Timber door guides are not recommended for large timber shutters.