

ELEVATION (VIEWED INSIDE LOOKING OUT)

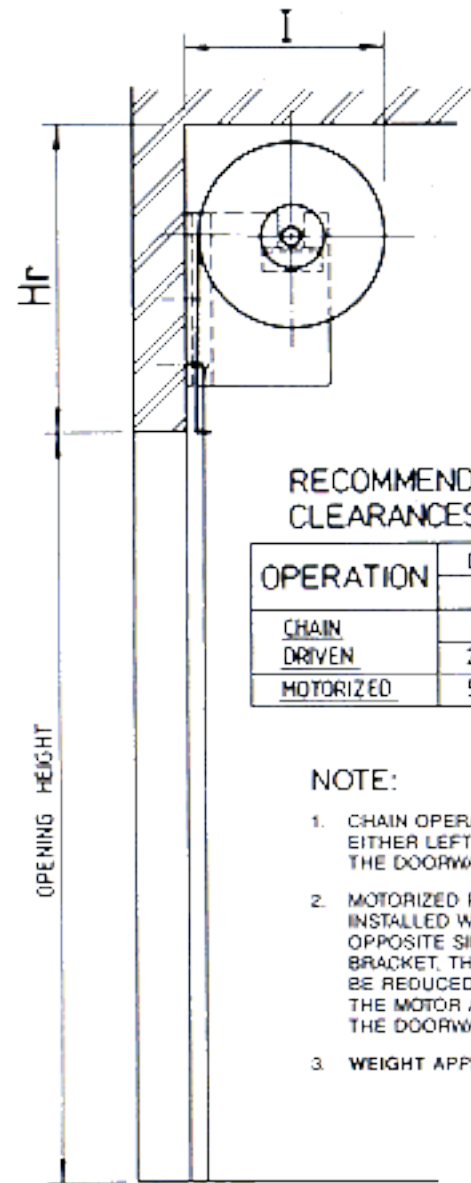

SECTION

RECOMMENDED SIDEROOM CLEARANCES:

OPERATION	MARK (mm)			
	DRIVEN END	PLAIN END		
CHAIN DRIVEN	G	L	P	R
MOTORIZED	265	190	250	170

NOTE:

1. CHAIN OPERATION MAY BE FITTED, ON EITHER LEFT OR RIGHT HAND SIDE OF THE DOORWAY OPENING.
2. MOTORIZED ROLLER SHUTTERS CAN BE INSTALLED WITH MOTOR FITTED TO THE OPPOSITE SIDE OF MOTOR SUPPORT BRACKET, THEREFORE SIDEROOM CAN BE REDUCED TO 250mm, THUS LEAVING THE MOTOR AND HAND CHAIN TOWARD THE DOORWAY OPENING.
3. WEIGHT APPROXIMATELY 24 Kg/m²



PLAN

NOTE:

1. WHERE ROLLER GRILLE DOORS ARE TO BE INSTALLED, ALL DOORWAY OPENINGS SHOULD BE KEPT CLEAR OF ANY OBSTRUCTION. (E.G. BEAMS, PIPES, ETC...)
2. WHERE DOORS ARE TO BE FITTED IN A CAVITY BULKHEAD SITUATION DUE ALLOWANCES SHOULD BE MADE TO DIMENSION "I" - 600mm CLEAR - FOR FIXING AND LIFTING PURPOSES.

HEIGHT UP TO (mm)	MARK (mm)		
	Hr	B	I
2400	545	380	330
3000	575	390	365
3600	600	400	400

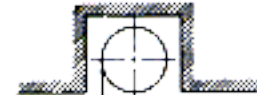

FOR MOTORIZED DOORS - SEE ROLLER SHUTTER DETAILS